

1F



Neurosurgery  
Neurology  
Common Examination Room

- ①Community Medical Cooperation Room (for those with a letter of referral)
- ②Initial medical examination  
Medical checkups, checkups, vaccinations
- ③Documents (medical certificates, etc.)
- ④Hospitalization settlement/payment consultation
- ⑤Accounting (calculation)

Medication delivery entrance

Entrance for emergency team

After-hours Entrance

Medical Consultation Room

Main Entrance

Emergency Outpatient 16

Disaster Prevention Center  
After-hours Reception

Entrance Hall

Patient Support Center

Central Blood Collection/  
Urinalysis Room/  
Central Treatment Room

Medication Counseling Room

Reception of hospitalization

Diagnostic Imaging

Diagnostic Imaging 17

Nutrition Counseling Room

Automatic Teller Machine

Insurance Confirmation Corner

General Information

Nuclear Medicine (RI) 18

Internal Medicine 10

Surgery  
Neurosurgery 11  
Orthopedic Surgery

Outpatient  
Chemotherapy Room 14

Light Garden

Vending machine  
Corner ATM

Nursing Consultation Room

East Entrance

BUS

TAXI

Radiation Therapy 19

Endoscopy Room 15

Psychiatry/Child Psychiatry  
Urology 12

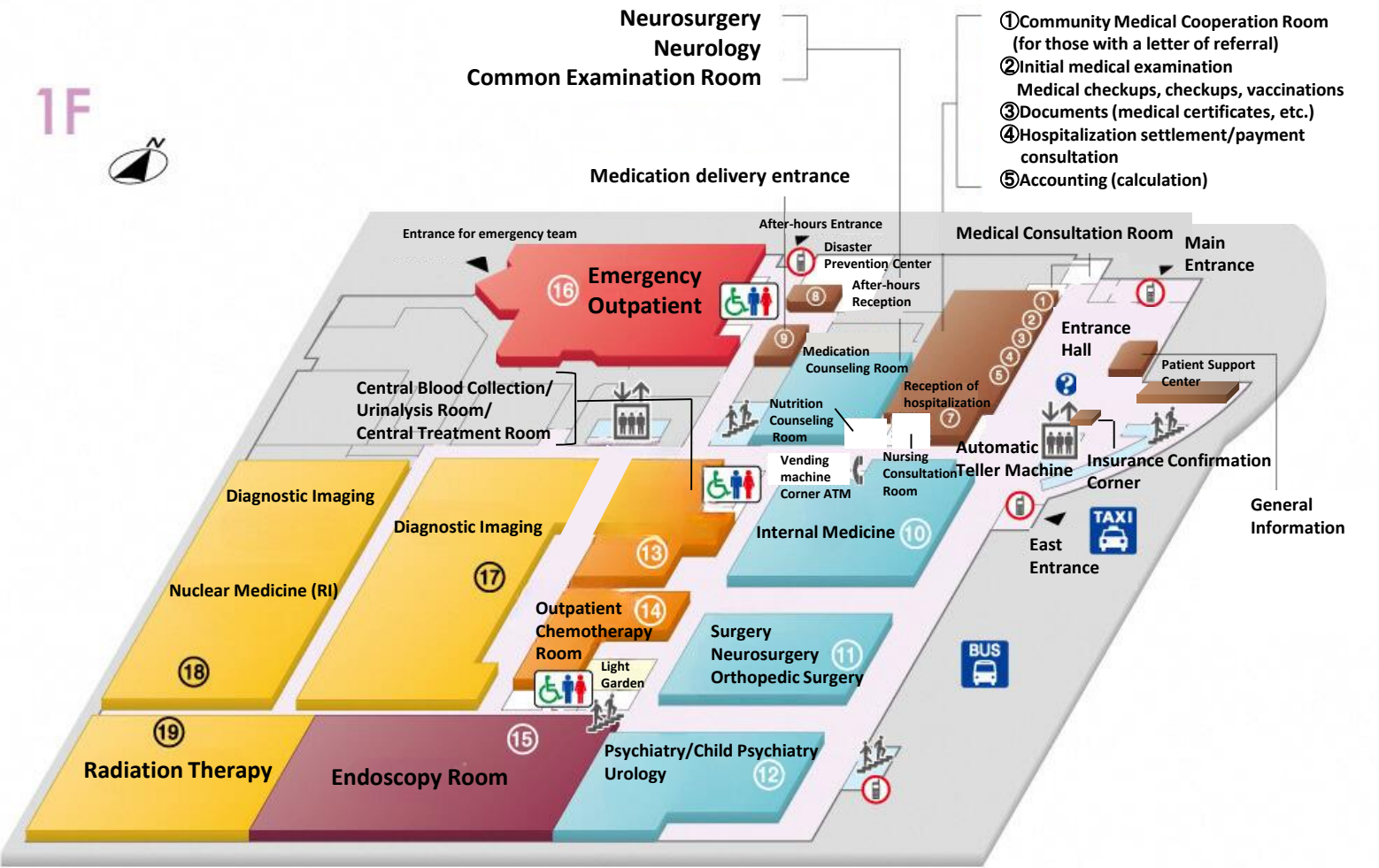

2F



Shop

Proton Therapy Center  
Multi-storey car park Liaison corridor



Coffee Shop

3F



# Perinatal Medical Center

Division of Neonatal Care

Division of Maternal and Fetal Medicine

**3F West Ward**

**3F East Ward**

NICU · GCU

LDR · MFICU · Maternity Ward 301~324

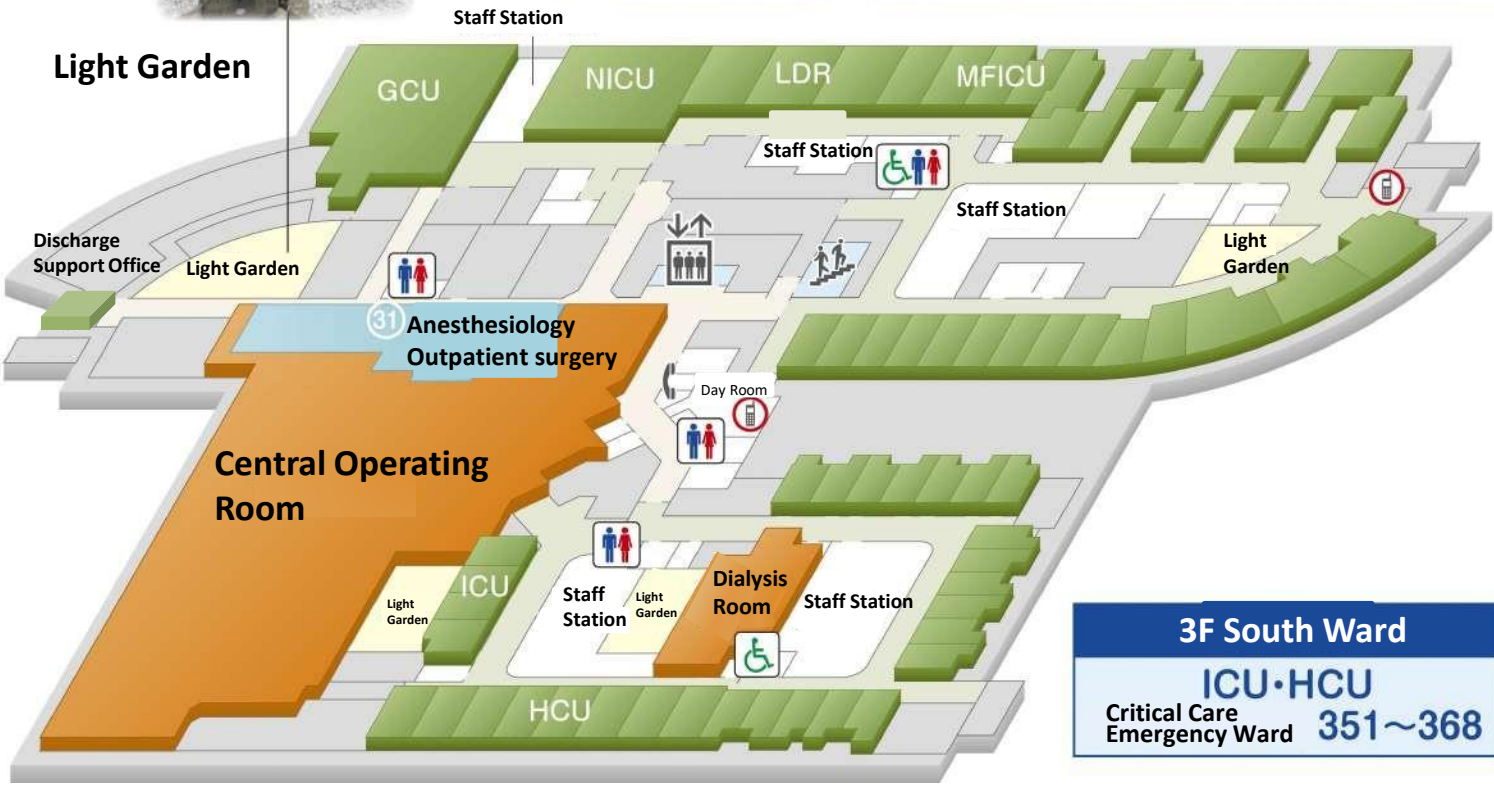

**3F South Ward**  
 ICU · HCU  
 Critical Care  
 Emergency Ward 351~368

4F



Reproductive Medical Center

Children's Medical Center

4F East Ward  
401~432

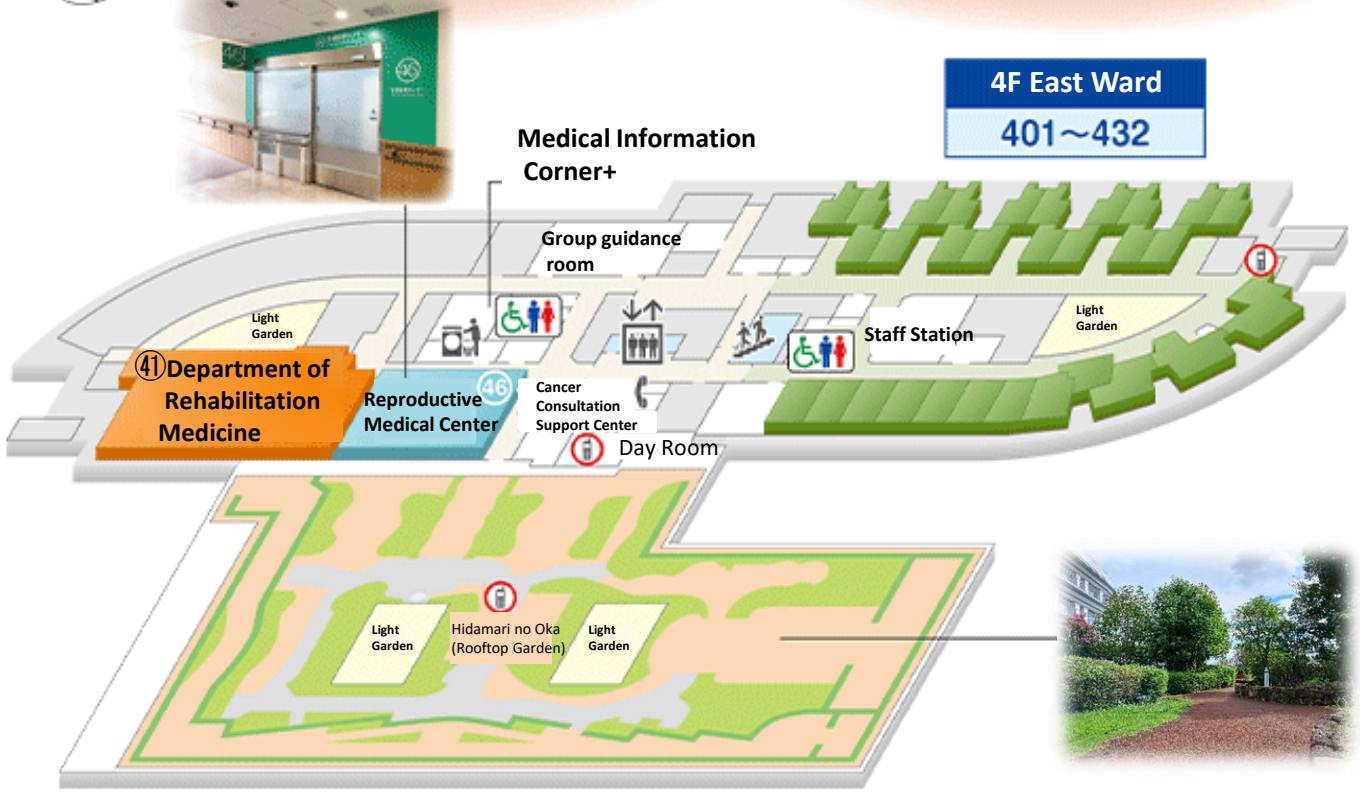

Hidamari no Oka  
(Rooftop Garden)

5F 

Women's Ward

5F West Ward  
551~576

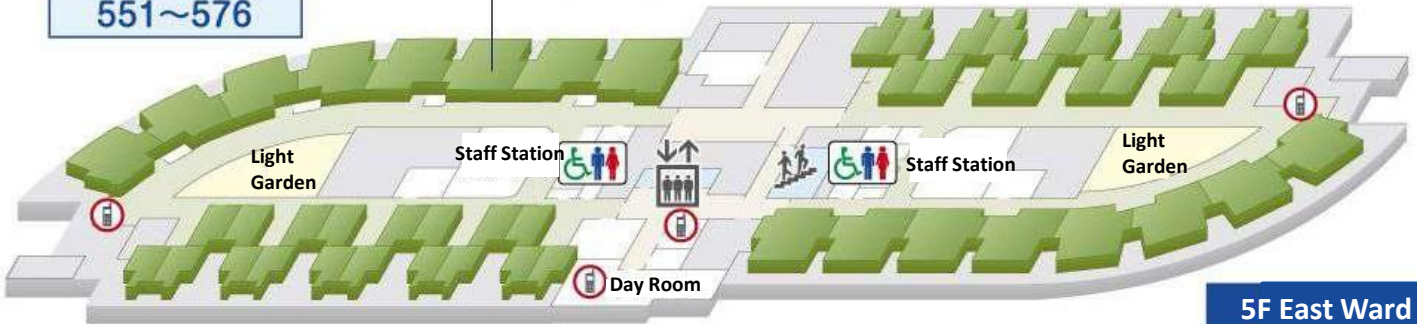

5F East Ward  
501~526

6F 

6F West Ward  
651~676

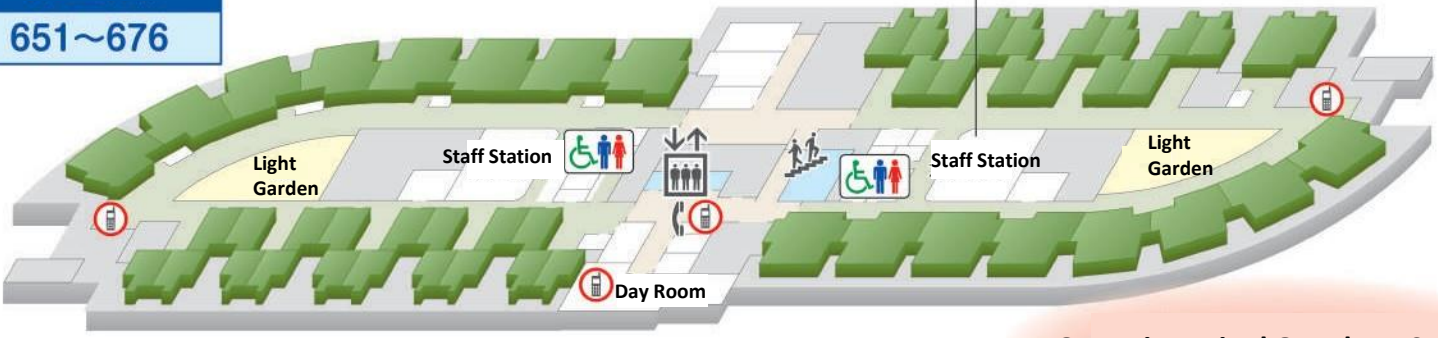

Gastrointestinal Oncology Center

6F East Ward  
601~623

# 7F



7F West Ward

751~776

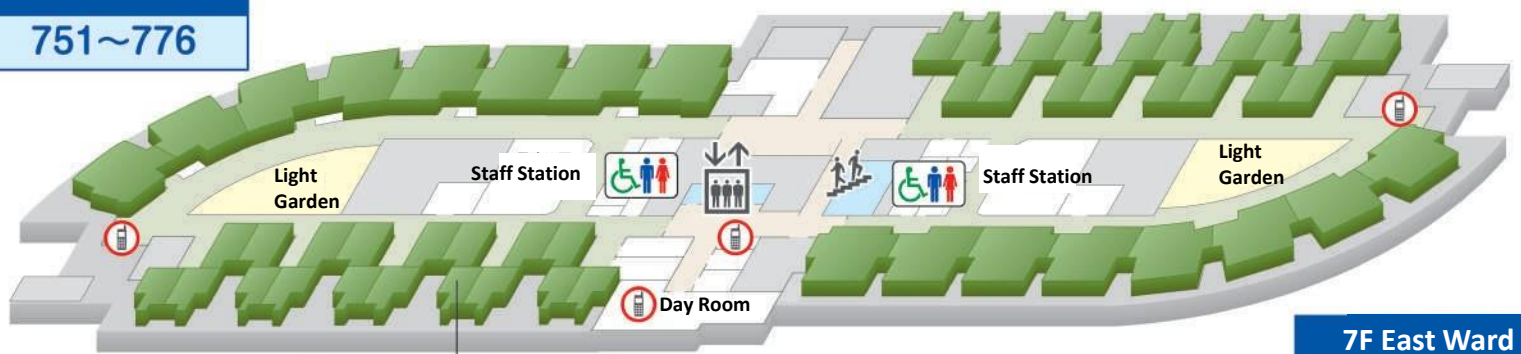

7F East Ward

701~726



8F



8F Ward

801~824

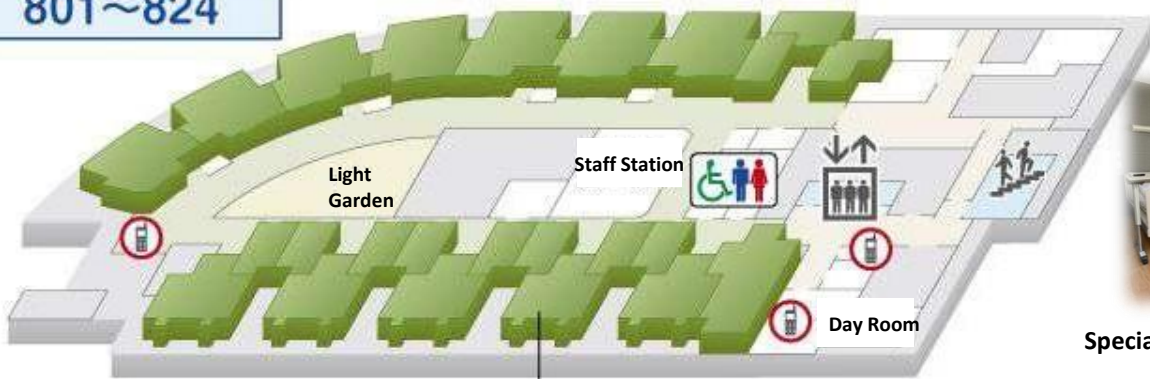

Special Private Room A